

*Savor the Lifestyle...
Sonoma Southside*

Merlot
ONE BEDROOM
ONE BATH
745 SQUARE FEET

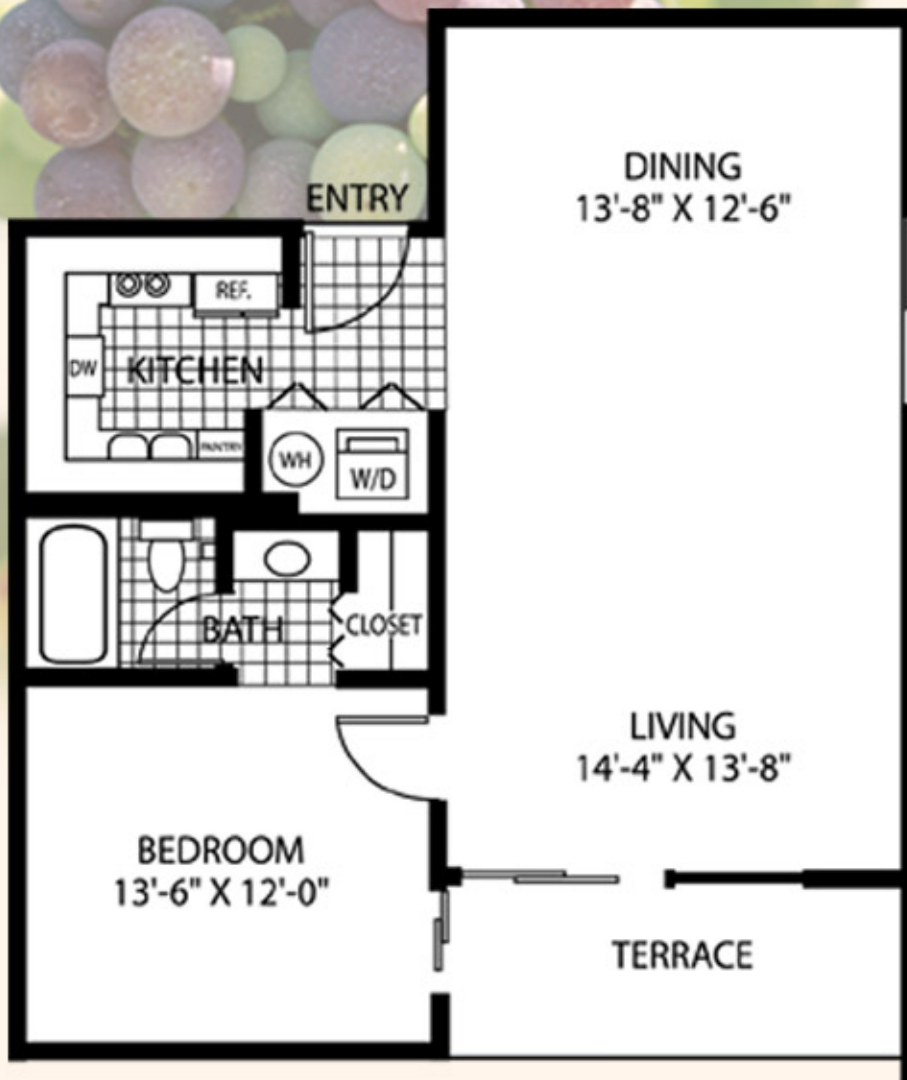

SPACIOUS FLOORPLANS • WASHER/DRYER CONNECTION • MICROWAVES • ENERGY EFFICIENT GE APPLIANCES
DESIGNER GRANITE KITCHEN COUNTERS/BACKSPASHES • CULTURED MARBLE BATHROOM VANITY TOPS
STAINED WOOD EUROPEAN STYLED KITCHEN & BATH CABINTRY • UPGRADED KITCHEN & BATHROOM SINKS & FAUCETS
UPGRADED CERAMIC TILE FLOORING IN FOYER KITCHEN & BATHROOM • CROWN MOLDING IN THE LIVING & DINING ROOMS
UPDATED CEILING LIGHT FIXTURES IN THE FOYER, KITCHEN & BATHROOMS • PRIVATE SCREENED TERRACES
LUXURIOUS CARPETING IN LIVING/DINING ROOMS, BEDROOMS, CLOSETS & HALLWAYS • OVERSIZED WINDOWS



Artist conception only. Oral representations cannot be relied upon as stating representations of the developer. For correct representations, reference the prospectus and to the documents required by Section 718.503 Florida Statutes, to be furnished by developer to buyer or lessee. Prices and specifications subject to change without notice.