

# THE DOMINIQUE

The majestic Dominique collection is a two-story home unparalleled in stature and opulence.

This dramatic home is accentuated with many special features, such as a two-story foyer and living room complete with expansive glass, formal dining area, and well-appointed kitchen with adjoining breakfast area and a large family room accessible to the covered lanai and optional outdoor kitchen.

The expansive master bedroom suite offers an array of standard features including a coffered ceiling, two walk-in closets, an exercise room, and a luxurious master bath complete with his-and-hers vanities, Roman tub, walk around shower, and private water closet.

Upstairs, a spacious loft overlooks the formal living room and leads to three additional bedrooms. Additional features include a private first-floor guest suite, study with double-doors, conveniently located powder room, separate laundry room, and three-car garage.

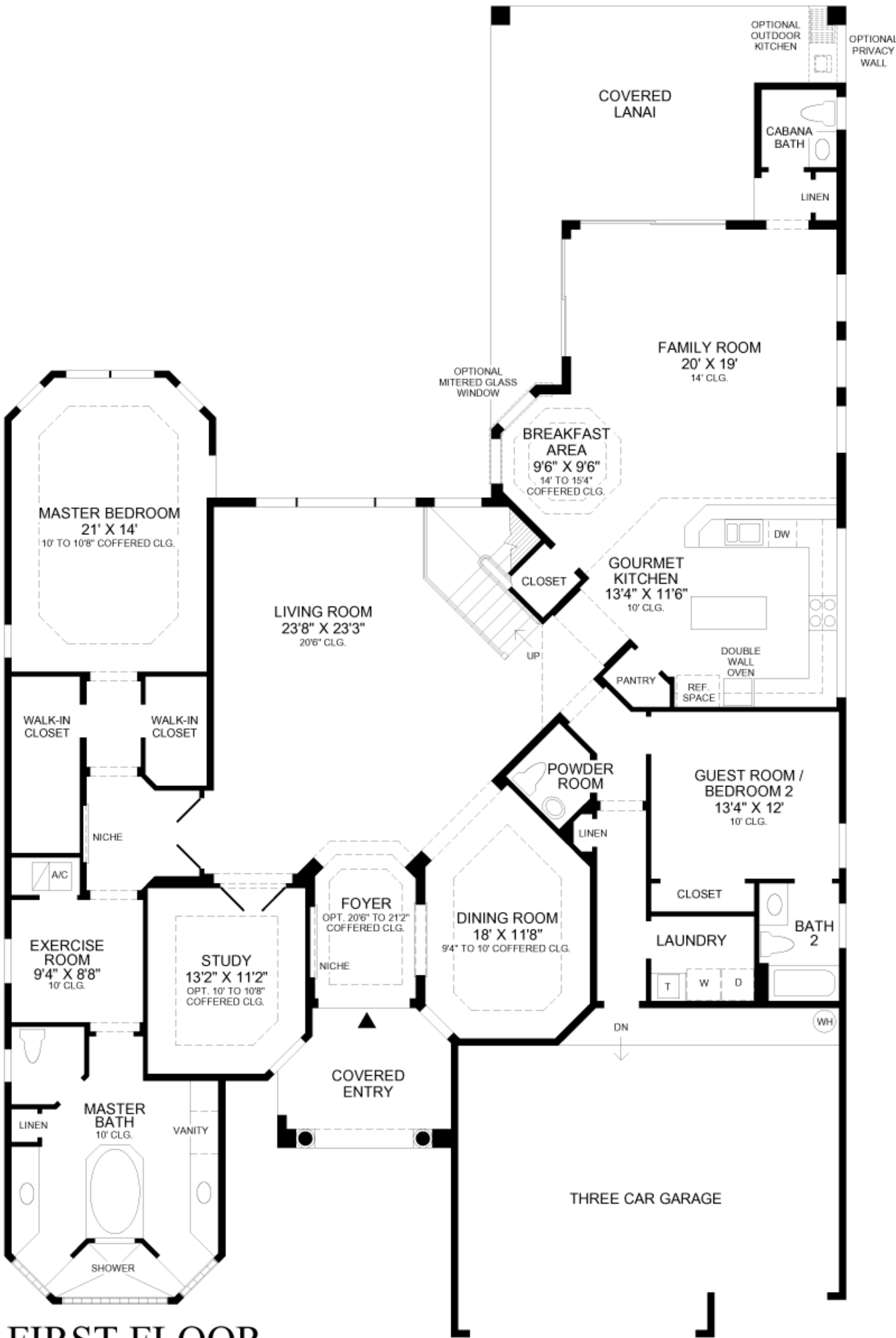

FIRST FLOOR

First Floor	3148 sq. ft.
Second Floor	1206 sq. ft.
Air Conditioned Living Area	4354 sq. ft.
Covered Lanai	380 sq. ft.
Covered Entry	111 sq. ft.
Garage	605 sq. ft.
<b>Total</b>	<b>4975 sq. ft.</b>

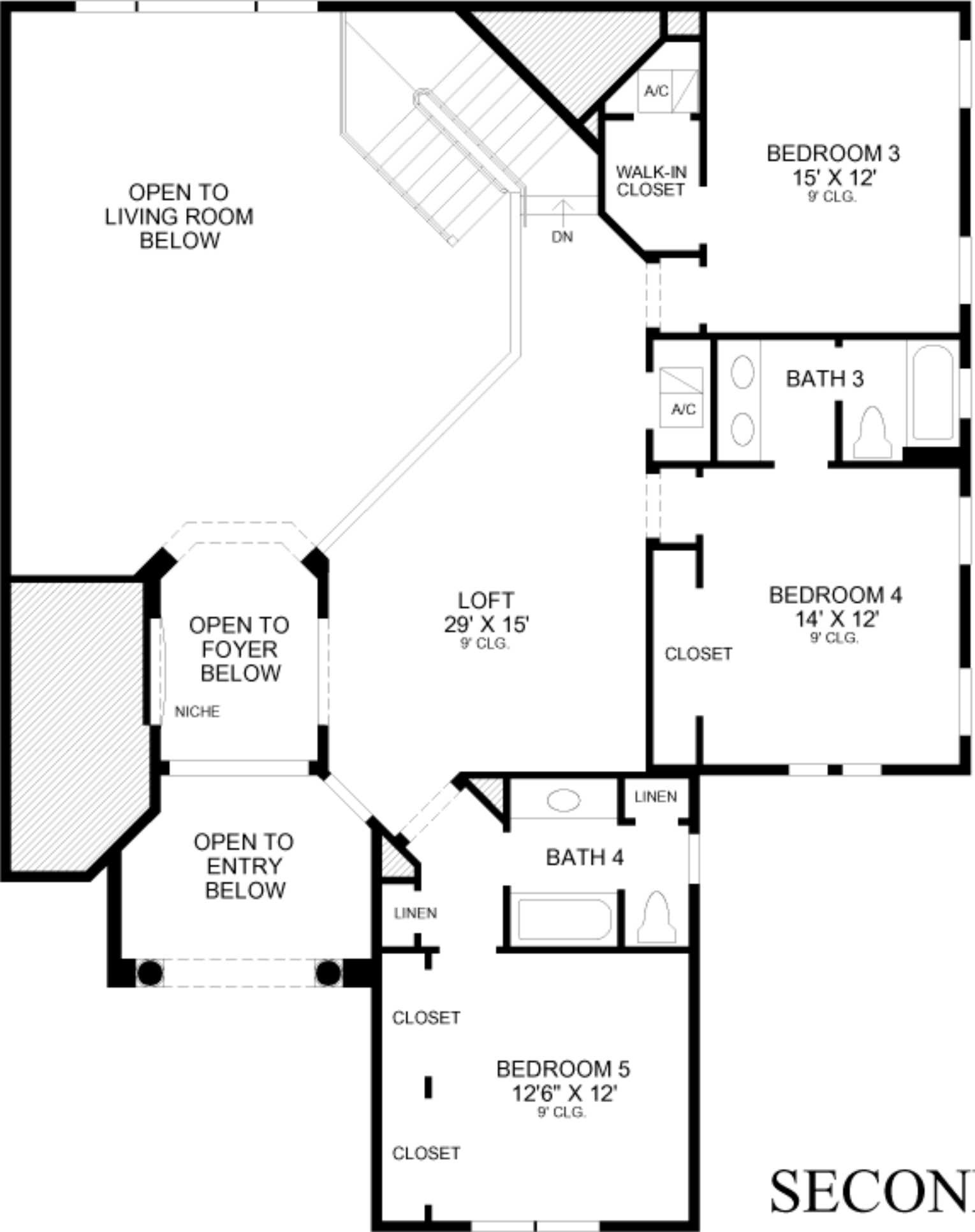

SECOND FLOOR

All dimensions are approximate, shown to the maximum dimensions of each room, and are subject to field variation. Dimensions should not be used to calculate room square footage. Some windows, exterior features, ceiling heights, and floor plans may vary with elevations. Features may also vary from community to community. Please consult a Sales Representative for details. Options purchased must be specified in exhibit B.

