

# THE RINALDI

A welcoming covered entry leads to an elegant foyer that provides the ideal setting for lavish entertaining by combining with an expansive living room and a formal dining room, both highlighted by a coffered ceiling.

The well-equipped gourmet kitchen opens to a sunlit breakfast area and a generous family room with large glass doors that open to the covered lanai.

The spacious master bedroom suite has private access to the covered lanai and features a cozy sitting area, a coffered ceiling, two-walk in closets and a sumptuous master bath complete with his-and-her vanities, Roman tub, separate shower, and private water closet.

This split plan home is further enhanced by three additional bedrooms, a private study with double-doors, a conveniently located powder room, a separate laundry room and a two-car garage with ample storage.

DRAFT

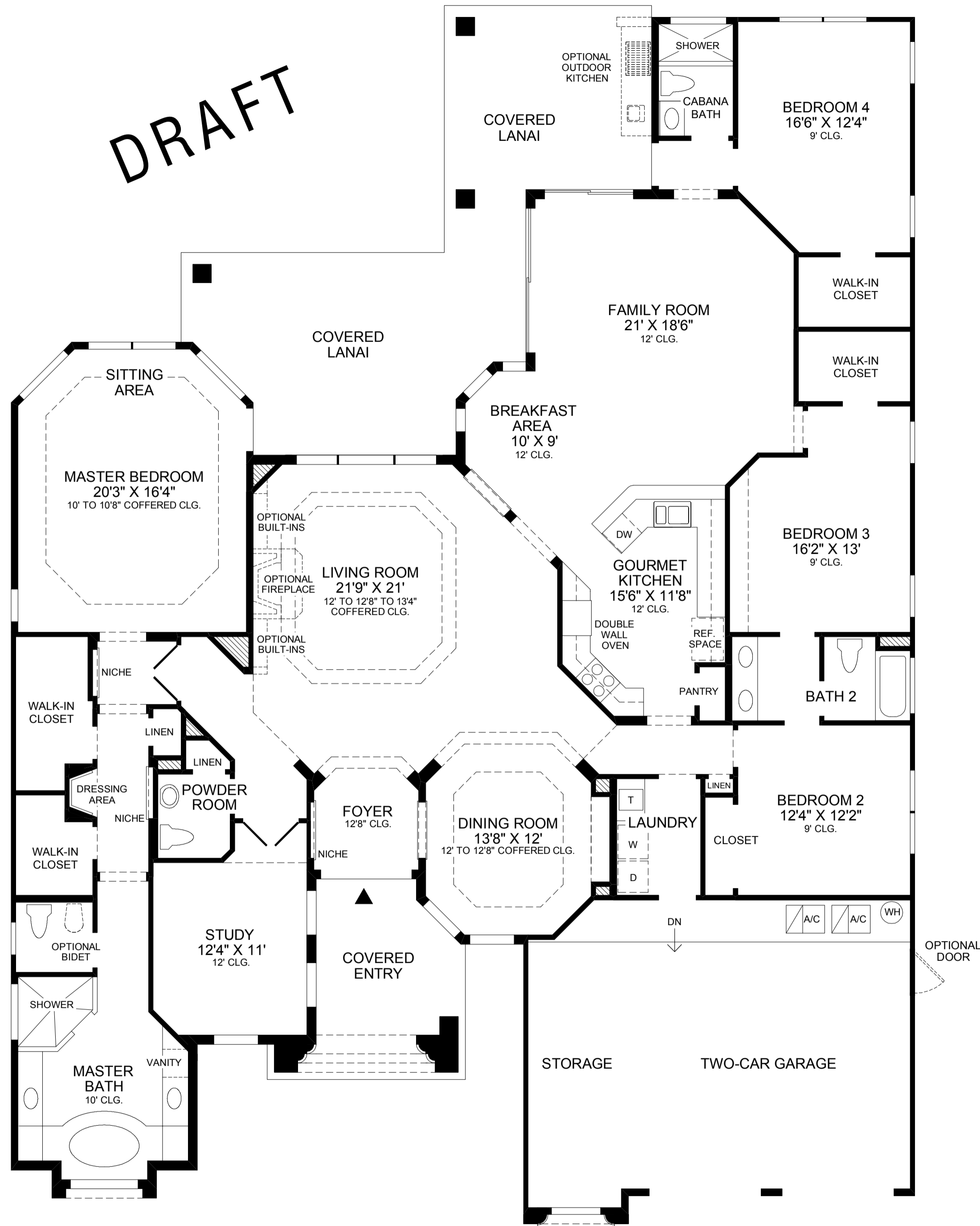

FLOOR PLAN

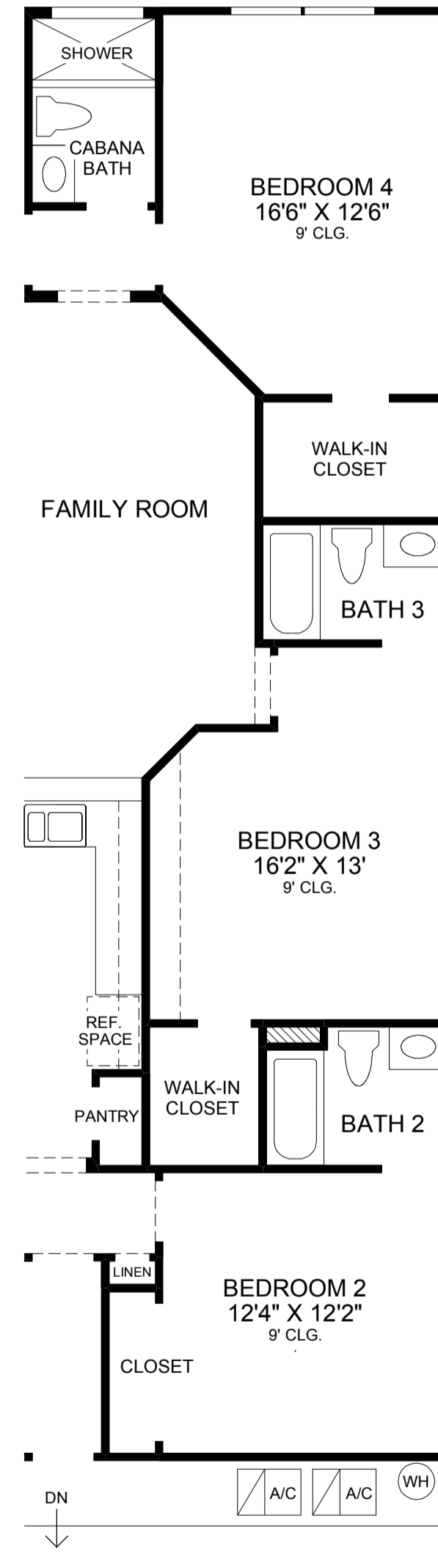

OPTIONAL ADDITIONAL BATH

Air Conditioned Living Area	3345 sq. ft.
Covered Lanai	470 sq. ft.
Covered Entry	129 sq. ft.
Garage	593 sq. ft.
<b>Total</b>	<b>4537 sq. ft.</b>

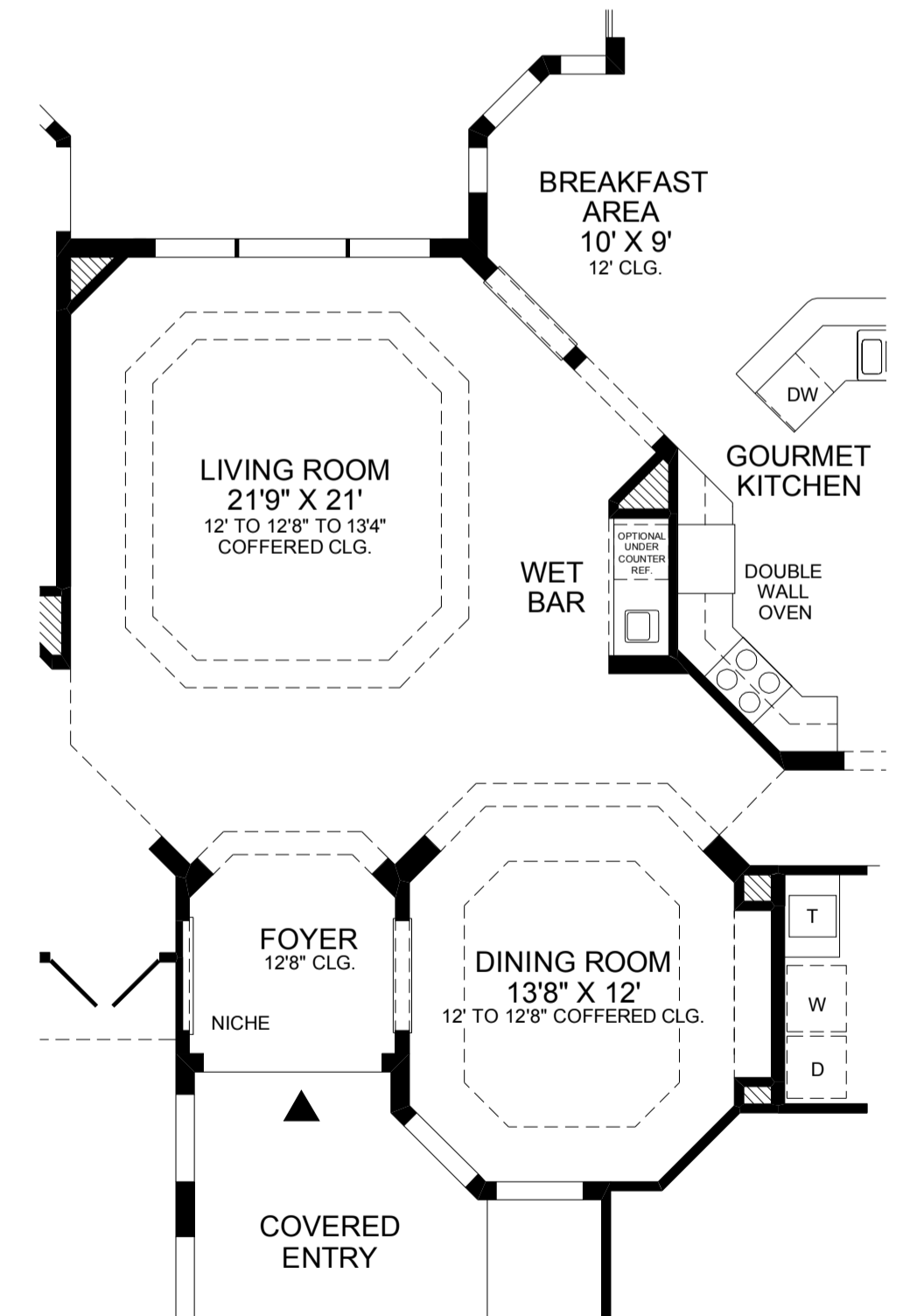

OPTIONAL WET BAR

All dimensions are approximate, shown to the maximum dimensions of each room, and are subject to field variation. Dimensions should not be used to calculate room square footage. Some windows, exterior features, ceiling heights, and floor plans may vary with elevations. Features may also vary from community to community. Please consult a Sales Manager for details. Options purchased must be specified in exhibit B.